

| | |
|-----------------------------------|--------------------------|
| 阻值范围 Resistance range | 5~250K Ω |
| 阻值允许误差 Tolerance of resistance | $\pm 20\%$ 0.05W |
| 额定功率 power Rating | 50V AC/ DC 20V |
| 额定电压 Rated voltage | 10 Ω max |
| 终端电阻 Terminal resistance | $\leq 100\text{mV}$ |
| 转动噪声 Rotational noise | DC250V 100M Ω min |
| 绝缘电阻 Insulation resistance | |

| | |
|---------------------------------|---------------------|
| 耐电压 Withstanding Voltage | AC300V 1minute |
| 总机械旋转角度 Total rotation angle | 270 $\pm 5^\circ$ |
| 动作力 Operating force | 10~80gf.cm |
| 止挡强度 Shaft Stopper Strength | 3Kgf.cm min |
| 机械耐久性 Mechanical endurance | 10000周/min turns |

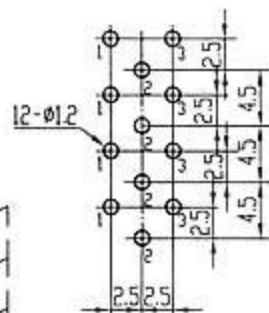
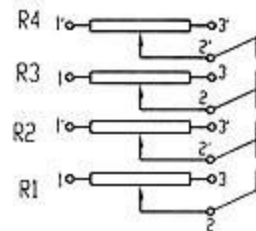
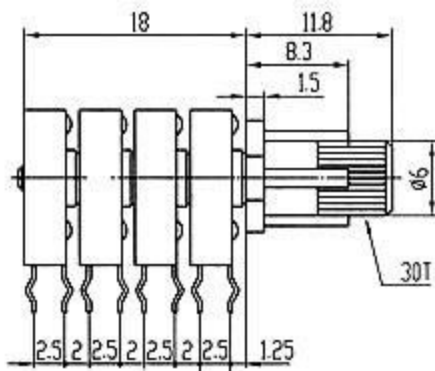
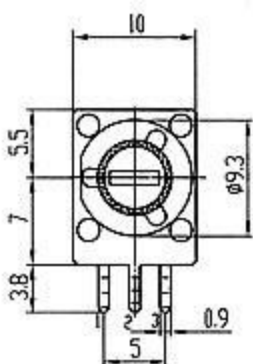

Standard Shaft Size:

●18T

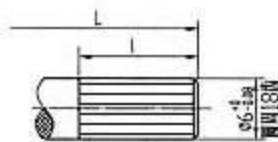

L

-

20

25

30

35

l

-

7

7

7

7

●40T

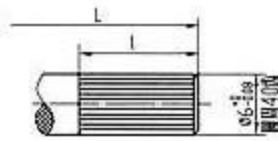

L

15

20

25

30

35

l

6

7

7

7

7

●F

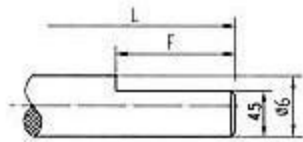

L

15

20

25

30

-

F

6

7

12

12

12